

# SHARP

## WARRANTY

Consumer Electronic Products

### Congratulations on Your Purchase!

This Sharp product is warranted against faults in materials and manufacture for a period of twelve (12) months from the date of original purchase.

If service is required during the warranty period, please contact your nearest Sharp Approved Service Centre. These repairs would be carried out at no charge to the owner, subject to the conditions specified herein.

The owner is responsible for any transportation and insurance costs if the product has to be returned for repair.

This warranty does not extend to accessories or defects or injuries caused by or resulting from causes not attributable to faulty parts or the manufacture of the product, including but not limited to, defect or injury caused by or resulting from misuse, abuse, neglect, accidental damage, improper voltage, liquid spillage, vermin infestation, software, or any alterations made to the product which are not authorised by Sharp.

Please retain your sales documentation, as this should be produced to validate a warranty claim.

This warranty is in addition to and in no way limits, varies or excludes any express and implied rights and remedies under any relevant legislation in the country of sale.

### IMPORTANT

#### DO NOT RETURN THIS DOCUMENT TO SHARP

For your reference, please enter the particulars of your purchase below and retain, with your purchase documentation.

Model No. \_\_\_\_\_

Serial No. \_\_\_\_\_

Date of Purchase \_\_\_\_\_

Retailer \_\_\_\_\_

FOR LOCATION ENQUIRIES WITHIN

#### AUSTRALIA

REGARDING YOUR  
LOCAL

**SHARP APPROVED SERVICE CENTRE**

CALL THE

**SHARP SERVICE REFERRAL CENTRE**

**LOCAL CALL 1 300 135 022**

or visit our website

**www.sharp.net.au**

SHARP CORPORATION OF AUSTRALIA PTY. LIMITED  
ABN 40 003 039 405  
1 Huntingwood Drive Blacktown NSW 2148

FOR PRODUCTS PURCHASED IN

#### NEW ZEALAND

CONTACT YOUR SELLING DEALER/RETAILER  
OR CALL

**SHARP CUSTOMER SERVICES**

**TELEPHONE: 09 573 0111**

FACSIMILE: 09 573 0113

or contact our web site

**www.sharp.net.nz**

SHARP CORPORATION OF NEW ZEALAND LIMITED  
59 Hugo Johnston Drive  
Penrose, Auckland

**IMPORTANT NOTICE: This warranty applies only to products sold in Australia & New Zealand.**

# SHARP MICROWAVE TRIM KIT

MODEL NO. RKJ39S

PART IDENTIFICATION SHEET

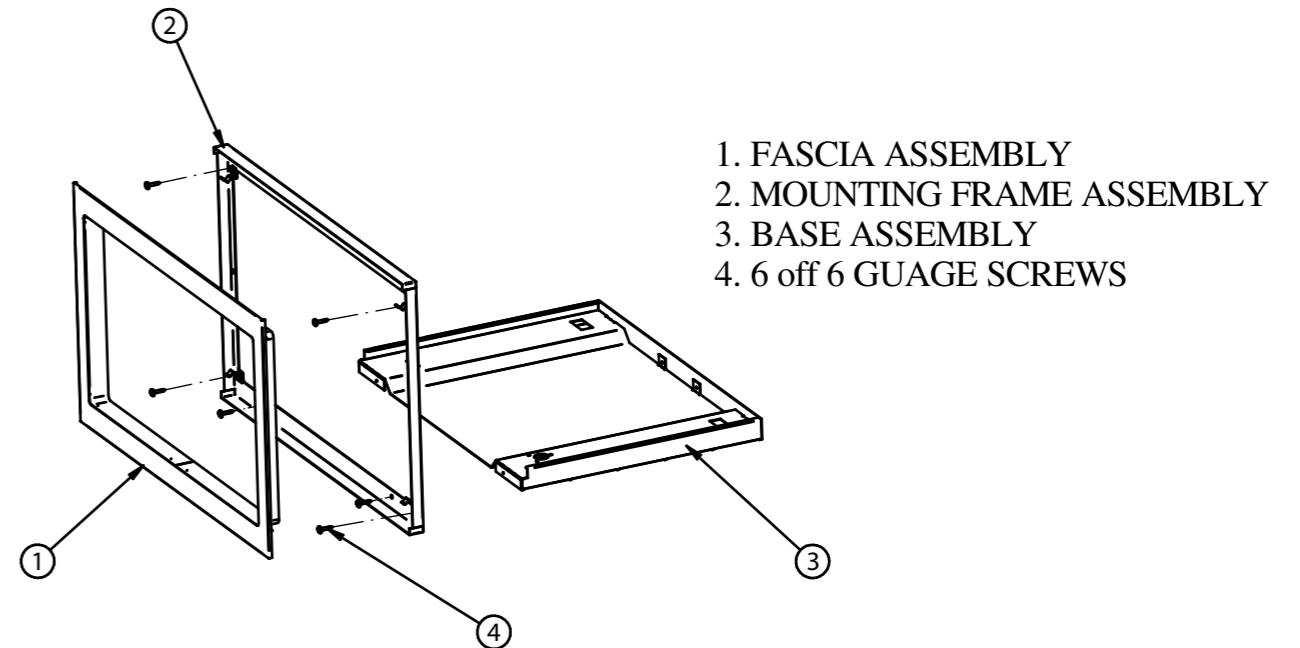

**“The RKJ39S is designed for the R395NS. Should you wish to use it for the R395FS please contact Sharp Customer Care Australia on 1300 135 022 (for Sharp Customer Care New Zealand contact 09 920 4147) for an alternate base”**

### CAUTION

1. Read and follow all of the instructions completely.
2. The Sharp Built-in Trim Kit must be installed in accordance with the full set of instructions listed and meet the regulations laid down by electrical authorities, building regulations and the requirements of state and local government authorities.
3. The microwave oven must be unplugged before installation of the Sharp Built-in Kit.
4. For safe use of the microwave oven, DO NOT modify or alter any part of this kit.
5. The kitchen cabinetry that houses the microwave oven must be constructed to allow the microwave oven to operate to Australian Standards 3350.1-2002, 60335.1, 3350.2.25-2001 and 60335.2.25.

### CARE AND CLEANING

Use a mild stainless steel cleaner applied with a soft damp cloth. Wipe in the stainless steel grain direction. DO NOT USE CAUSTIC CLEANERS, ABRASIVE OR HARSH CLEANERS OR SCOURING PADS.

### TRIM KIT SPECIFICATIONS

#### Cavity Dimensions

Internal Width 600mm  
External Front Height 381mm  
Depth 500mm (minimum)

#### Overall Kit Dimensions;

Width 596mm  
Height 380mm  
Depth 22mm (Fascia)

#### Cabinetry Ventilation

An opening on the upper cavity panel must be cut for air circulation. This opening should be placed at the rear- minimum 600mm x 100mm.

